

W 6008-2RS1 Deep groove ball bearings

- Popular item

Deep groove ball bearings

Bearing data

[Tolerances](#),

Normal (metric), P6, P5, Normal (inch),

[Radial internal clearance](#),

Matched bearing pairs, Stainless steel
 $d < 10$ mm, Other bearings

Bearing interfaces

[Seat tolerances for standard conditions](#),

[Tolerances and resultant fits](#)

Technical specification

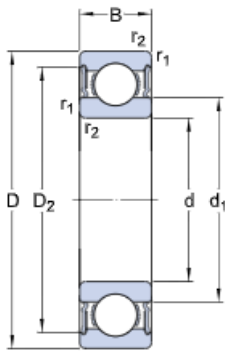

DIMENSIONS

d	40 mm	Bore diameter
D	68 mm	Outside diameter
B	15 mm	Width
d_1	≈ 49.2 mm	Shoulder diameter
d_2	≈ 49.2 mm	Recess diameter
D_2	≈ 62.5 mm	Recess diameter
$r_{1,2}$	min. 1 mm	Chamfer dimension

ABUTMENT DIMENSIONS

d_{ξ} min.	45 mm	Diameter of shaft abutment
d_{ξ} max.	49 mm	Diameter of shaft abutment
D_{ξ} max.	63.5 mm	Diameter of housing abutment
r_a max.	1 mm	Radius of shaft or housing fillet

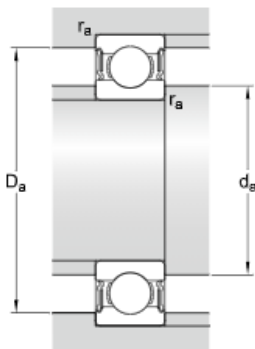

CALCULATION DATA

C	14.6 kN	Basic dynamic load rating
C ₀	11.4 kN	Basic static load rating
P _u	0.49 kN	Fatigue load limit
	6 300 r/min	Limiting speed
k _r	0.03	Minimum load factor
f ₀	15.2	Calculation factor

MASS

	0.18 kg	Mass bearing
--	---------	--------------

TOLERANCE CLASS

Normal	Dimensional tolerances
Normal	Radial run-out